

X-Protect

Impact

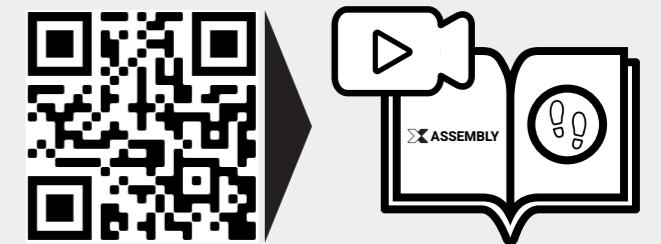

AXELENT AB
WWW.AXELENT.COM

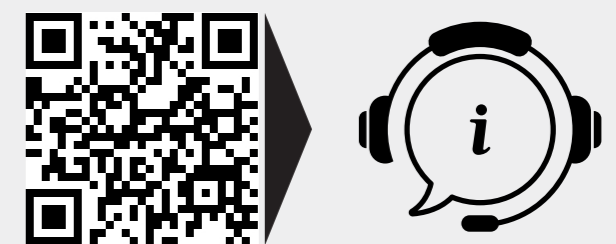

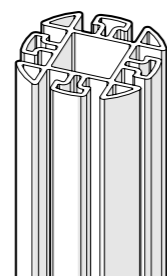

Art. PT102-305



Art. PT103-050

Art. PT103-304

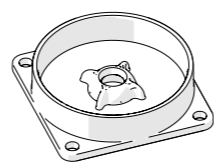

Art. PT116



Art. PT117-335

Art. 10-9696



Art. PT105

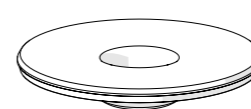

Art. PT118

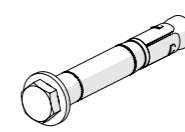

Art. 10-9695

BCE0-035-I100
BCM0-035-I100
BCC0-035-I100

1	1	3	1	1+1	1	1	4
1	2	2	1	1+1	1	1	4
1	2	2	1	1+1	1	1	4

CCS9-000-I100

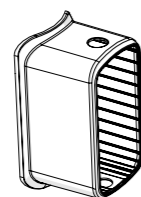

Art. PT108

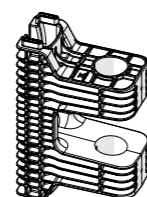

Art. PT109

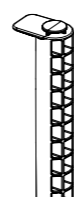

Art. PT111

BCE0-035-I100
BCM0-035-I100
BCC0-035-I100

1	1	1
2	2	2
2	2	2

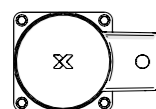

BCE0-035-I100

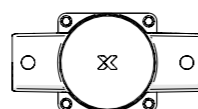

BCM0-035-I100

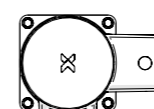

BCC0-035-I100

PT103-304	CCS9-000-I100	PT103-304	PT103-304		PT103-304	CCS9-000-I100	PT103-304	PT103-304		PT103-304	CCS9-000-I100	CCS9-000-I100	PT103-304	
	PT103-050					PT103-050		PT103-050			PT103-050	PT103-050		

RCI1-XXX-XXXX
(RCI1-length-centre to centre)



The pin hole location, size and adjacent material integrity are critical to the overall system function and performance. Axelent therefore advises against any onsite alterations as performance cannot be guaranteed.



